



Product Guide

25

BUILDING ON
25 YEARS OF
INNOVATION
EST. NZ 1999

mwnz.com

0800 776 9727

25

BUILDING ON
25 YEARS OF
INNOVATION
EST. NZ 1999

About Marshall Innovations

The Marshall Group was founded in 1998 when Sean and Lara Lett partnered with Mike Wheeler to venture into the Construction Supply Sector. Initially operating from Tauranga, they focused on offering a variety of window flashing tapes. Over time, Sean and Lara successfully expanded the business, eventually assuming sole ownership by the mid-2000s.

Marshall Innovations has established itself as a market leader in the construction industry, offering a wide range of products including house wraps, tapes, floating deck systems, and more. With a strong belief in the importance of quality and service, the family-owned business has thrived for 25 years.

Marshall Innovations products are accessible through top building merchants and a network of certified installers, emphasizing our commitment to providing high-quality, healthy homes to Kiwis.



Owners
Sean and Lara



Members of



Contents

Marshall Weatherization System	4
Tekton Wall Underlay	6
Hydra Wall Underlay	7
Hydra Roof Underlay	8
Super-Stick	9
Maxi-Butyl	10
Trade-Seal	11
Tuatara Guard Floor Protection	12
ProFoot Pedestal System	13
Stormcell	16
Pro-Drain 8 Drainage Board	17
Trade-Flash	18
Pro-Kickout Flashing & Pro-Joist	19



Bring on the elements

**One System,
One Specification,
One Supplier**

Marshall Weatherization System

The Marshall Weatherization System provides a complete weatherproof construction envelope, delivered by a single supplier. Marshall Innovations now offers the specifier a single point of contact, and a complete technical specification to simplify the design process. Marshall Weatherization System backed by a durability warranty of up to 50 years.

The full system consists of:

- 1 Tekton Wall Underlay
- 2 Hydra Roof Underlay
- 3 Construction Seam Tape
- 4 Super-Stick Or Prosill Tape
- 5 Trade-Seal
- 6 Hydra Wall Underlay

Benefits

- » Full system that combines a range of respected products to form a secure construction envelope
- » Ability to switch between HYDRA Wall Underlay and Tekton Wall Underlay
- » Highly compatible product integration
- » Can be exposed to UV and weather for up to 60 days
- » A system that combines superior strength, water hold-out and flexibility with ease of installation
- » Meets the requirements of the New Zealand Building Code (NZBC) Clause B2 Durability and Clause E2 External Moisture



1



2



3

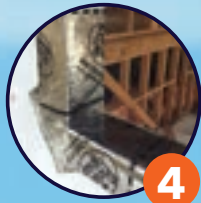

4



5



6



Tekton

House Wrap

Tekton Wall Underlay is a breathable, fire retardant flexible wall underlay. Tekton provides an extra layer of protection, securing the building envelope from the outside elements. Whilst blocking air and water from entering, Tekton's breathability allows internal moisture vapour out delivering the perfect balance between holdout and breathability.

Brand with your own logo & details

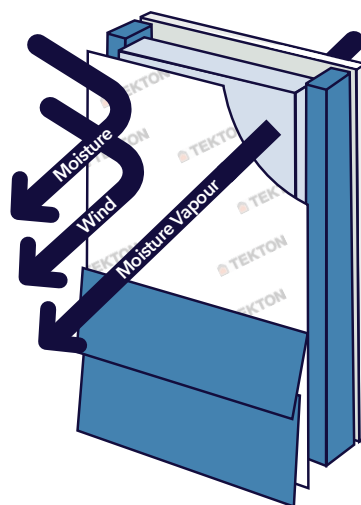

Benefits

- » Is breather type coated, spun-bonded polypropylene
- » Can be left exposed for 60 days
- » Superior water holdout. Taking the industry to a new level for water resistance.
- » Optimal surfactant resistance. Wash your building with confidence.
- » Fire retardant with the Highest Fire rating of all underlay in NZ. It has a 0 rating on the Flammability Index.
- » A leader in tear strength
- » Suitable for all wind zones including extra high when used with RAB Systems
- » Can be used with no internal wall linings, ie: gable ends.
- » Increases your building's energy efficiency
- » Used for residential and commercial applications
- » Will not support the growth of mould
- » Contains more than 23% recycled content
- » Forms part of the Marshall Weatherization System
- » Can be branded with customer's details

 **Flame Retardant**

Roll sizes

- ✓ 1370mm x 37m
 - ✓ 2740mm x 37m
-

 **TEKTON**

 **BRANZ Appraised**

Hydra Wall

Wall Underlay

HYDRA Wall Underlay is an absorbent, breathable, fire retardant, flexible wall underlay used behind all wall claddings. Suitable with absorbent and non-absorbent claddings in both direct and non-direct fixing.



Benefits

- » Is an absorbent synthetic underlay
- » Is a breathable type underlay
- » Flammability index rating of ≤ 5
- » Can be left exposed for 60 days
- » Suitable in all wind zones including extra high when used with Rigid Air Barriers
- » Can be used with no internal wall linings, ie: gable ends.
- » Used for residential and commercial applications
- » Suitable on timber and steel framing
- » Meets provisions of NZBC: B2, E2 & F2
- » Forms part of the Marshall Weatherization System



Absorbent



Flame Retardant

Roll sizes

- ✓ 1370mm x 37m
- ✓ 2740mm x 37m



Hydra Roof

Roof Underlay

HYDRA Roof is a breathable, fire retardant, self-supporting, tri-laminate, flexible underlay designed with HYDRA's GRIPSPOT™ technology for ultimate safety during roof construction.

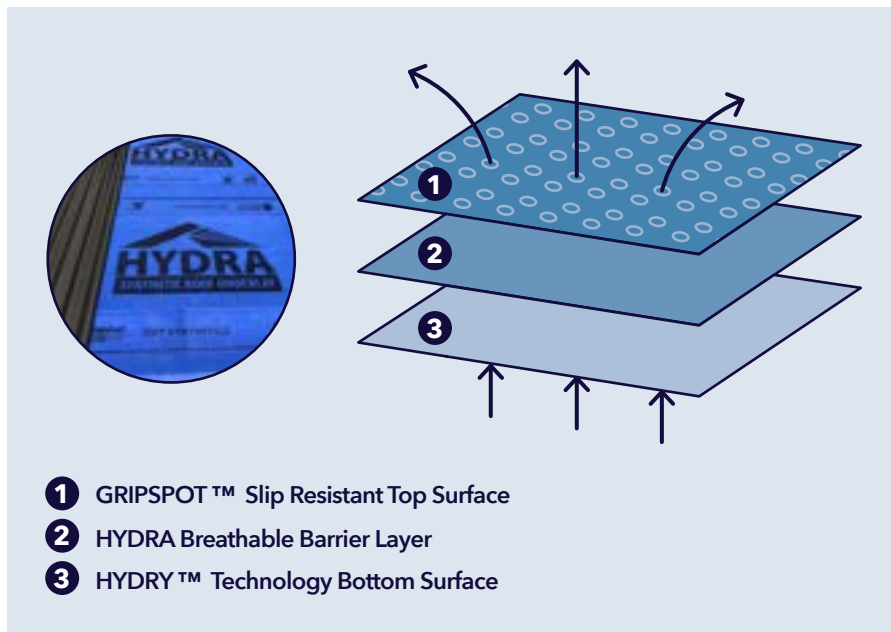

Benefits

- » Breathable, self-supporting, synthetic underlay
- » Fire retardant, flammability index of ≤ 5 as per AS1530
- » UV Exposure 14 days
- » Tri-laminate offers high strength and light weight
- » GripSpot provides a slip resistant walking surface
- » HYDRA Breathable Barrier Layer prevents water but allows for transfer of moisture vapour
- » HYDRY Technology bottom layer is designed to absorb moisture in the roof space
- » Suitable on timber and steel frame
- » Suitable with pressed metal and masonry tiles
- » Suitable with profiled metal roofing
- » Suitable in all Wind Zones stated in NZS 3604 up to and including, extra high
- » Forms part of the Marshall Weatherization System



Absorbent



Flame Retardant



**GRIPSPOT™
Walking Surface**



HYDRY™ Technology

Roll Sizes

- ✓ 1250mm x 20m
- ✓ 1250mm x 40m
- ✓ 2500mm x 40m



Super-Stick

Building Tape

Marshall innovations Super-Stick Building Tape is a high performance window and door flashing tape designed to be installed down to -6°C. No more issues regarding adhesion in the cool of winter or the heat of summer. No additional primers or mechanical fasteners required.

Super-Stick Building Tape utilizes a high tack pressure sensitive adhesive (PSA) combined with a high performance toughened film.



Benefits

- » Can be installed in extremely cold conditions to -6 deg °C
- » Easy to install peel-and-stick application
- » UV resistant for 90 days
- » Compatible with most sealants, check suitability with sealant manufacturer
- » Can be used with RAB systems - fibre cement sheets
- » Split back liner for easy install
- » Can be installed in very hot conditions
- » Extremely high puncture resistance and tensile strength
- » Residential and commercial application
- » Very thin and no build up, won't affect cavity battens or window installation

A greener solution

No VOC's, No HFCC's, No CFC's
No off-gassing, Non-allergenic
Non-toxicity

Tape sizes

- ✓ 75mm x 23m
- ✓ 150mm x 23m
- ✓ 200mm x 23m



Maxi-Butyl

Flashing Tape

Maxi-Butyl Flashing Tape is a self-adhered, waterproof, flexible butyl flashing tape designed for use around joinery openings, penetrations, sealing and flashing underlays to substrates, mechanical flashings and other surfaces.

But going beyond the fundamentals, it's formulated without VOC's, and is compatible with most sealants used for window installation. Compared to rubberized asphalt-based flashings, Maxi-Butyl Flashing Tape simply brings more to the job. It's pliable in cold weather. It's stable at high temperatures. Plus it maintains a flexible, but tight seal for far greater durability and long-lasting performance.

Maxi-Butyl Flashing Tape definitely delivers on the basics. It's designed to peel quickly, stick fast and with only one layer required, it helps keep projects on budget.



Benefits

- » Only one layer required
- » Easy to install with split release liner on the 150 and 200mm tapes
- » No VOC's; compatible with most sealants, check compatibility with sealant manufacturer.
- » Performs over a broad temperature range
- » 180 day UV Exposure
- » 100% Butyl for Maximum Adhesion

Surface Compatibility

- » Spun-bonded polyethylene and non-woven polyolefin building wraps
- » Cured concrete and cement
- » Moisture-resistant plasterboard
- » Aluminium and steel, including galvanised.

Tape Sizes

- ✓ 75mm x 23m
- ✓ 150mm x 23m
- ✓ 200mm x 23m



Trade-Seal

Flashing System

Building envelope penetration seal. A one piece self adhesive collar for sealing around pipe and conduit.

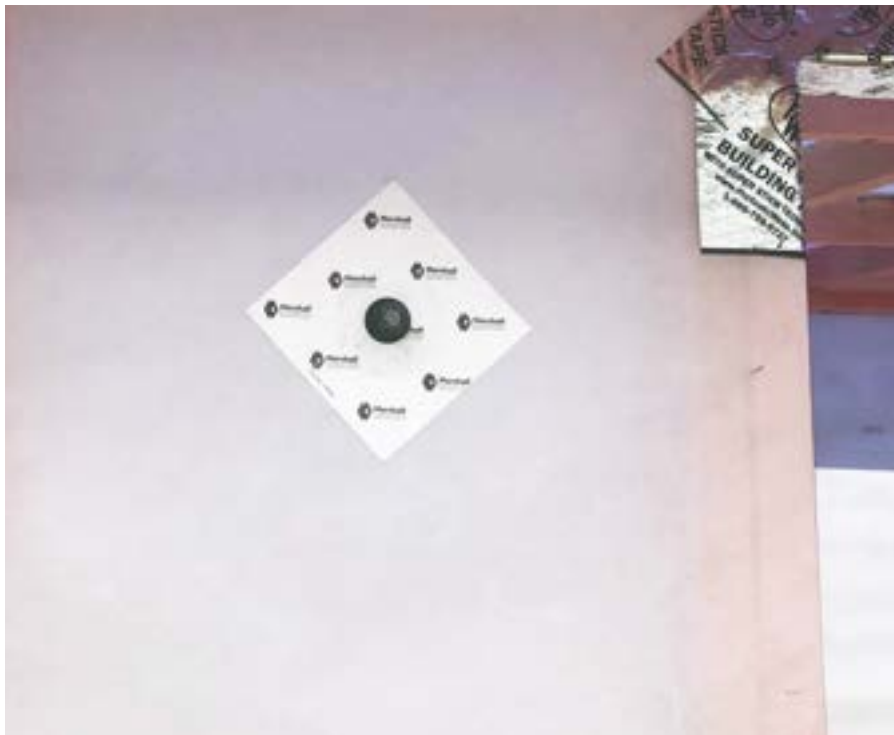

Benefits

- » A one component secondary flashing system
- » Can be used on all accepted wall underlays including bituminous paper.
- » Can be installed on the inside of RAB systems and wall underlays - retrofit installation.
- » Requires no adhesives to hold in place
- » Can be exposed to weather and UV for up to 90 days
- » Will adhere to most clean and dry substrates including fibre cement and Ply RAB board
- » Forms part of the Marshall Weatherization System

Sizes

Sizes available to fit 8mm to 220mm diameter.

- ✓ 8-12mm
- ✓ 15-22mm
- ✓ 25-32mm
- ✓ 42-55mm
- ✓ 50-70mm
- ✓ 75-90mm
- ✓ 100-110mm
- ✓ 150-165mm
- ✓ 200-220mm

Tuatara Guard

Temporary Floor Protection

Tuatara Guard Temporary Floor Protection is a spill absorbent membrane with built-in cushion technology. Featuring a patented slip resistant GripSpot walking surface that reduces movement on floors.

Designed to absorb spills without reducing its tear strength or staining the floor below. Can be used multiple times, surface can be easily cleaned through wiping or vacuuming.



Benefits

- » 960mm x 30m = 28.8m² of coverage
- » Re-usable
- » Shock absorbing cushion technology
- » Spill absorbent without reducing strength
- » Slip resistant GripSpot Technology
- » Anti-Slip back surface
- » Product won't stain or mark floors
- » TUATARA Tape available
- » Recyclable

Note: Not suitable where breathable protection is required, e.g., polished concrete floors.



GRIPSPOT™
Walking Surface



Profoot

Profoot Deck Jack System

The ProFoot Adjustable Pedestal Range creates that seamless indoor outdoor flow that is part of the kiwi lifestyle.

Adjustable pedestal solutions from 10mm to 500mm+ Versatile applications, thanks to a modular system comprising of various base pedestals.

Extension rings which provide a simple solution to achieve additional height where required, in conjunction with a range of adapters to suit timber, stone or the EVO aluminim range.



PRO XXS

Suitable for timber or stone. Comes with 'L' & Stone adapter.

Code: EPROXXS
Size: 10 - 15mm
With XXS extensions plates 10-25mm



PRO XS

Suitable for timber or stone. Comes with 'L' & Stone adapter.

Code: EPROXS
Size: 22-30mm



Pro Small

Code: EPROS
Size: 30-53mm



Pro Medium

Code: EPROM
Size: 53-82mm



PRO Large

Code: EPROL
Size: 70 -117mm



PRO XL

Code: EPROXL
Size: 74 -168mm



PRO-M SL and PRO L SL

PRO M SL: Self-levelling up to 8%

Code: EPROMSL
Size: 55mm - 84mm

PRO L SL: Self-levelling

Code: EPROLSL
Size: 73mm - 102mm



EPDM Disc

Supports timber & stone. Reduces sound transmission. Can be stacked 3 high

Code: EPAD
Size: 120mm Ø x 10mm

Profoot

Aluminium Profile Systems

EVO Aluminium profile provides a straight, true and dimensionally stable sub-structure for both timber decks and stone patios.

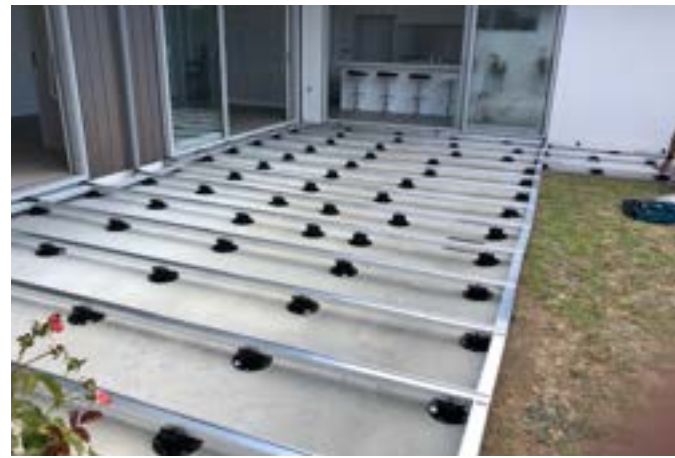

EVO Profile

Code: EV040
Size: 60mm x 40mm x 4.0m



EVO Slim

Code: EVOSLIM
Size: 60mm x 20mm x 4.0m



EVO Corner Connector

Code: EVOCNR
Size: 40mm x 25mm x 40mm



EVO Connector

Code: EVOCON40
Size: 24mm x 50mm x 200mm



EVO Slim Connector

Code: EVOSLIMCON
Size: 4mm x 48mm x 200mm



180° EVO joint

Freely rotating joint angles up to 90 degrees
Code: E180J



90° EVO joint

Freely rotating joint. Form vertical to horizontal junctions
Code: E090J



EVO Wall Connector

Secure EVO system to the structure
Code: EVOWCON
Size: 100mm x 30mm



Hapatec Timber Screw (500 pieces)

Code: E100052
Size: 5.0 x 60mm
Code: E100053
Size: 5.0 x 70mm



Profile Drilling Screws A4 TX 25

Code: E100052
Size: 5.0 x 60mm
Code: E100053
Size: 5.0 x 70mm



Twin system clip

For hidden fastening of decking with grooved sides
Code: ETWINC
Size: 20,5 x 2 x 30 mm

Profoot

Accessories

Profoot Accessories offer a wide range of options for timber, tile and composite decks. Contact our team to help design your deck and achieve a great outdoor living space.



PRO XXS

Extension Plate. Suitable for PRO XXS

Code: EPROEXPLT

Size: 5.0mm



PRO Wedge

For excessive falls such as around scuppers or drains.

Adjustment from 0% - 10%

Code: EWEDGE10



PRO Extension Ring

Increase the height of PRO S, M, L, XL & PROMSL PROLSL pedestals by 40mm increments.

Code: EEXT040

Size: 40mm



PRO Extension Ring

Increase the height of PRO S, M, L, XL & PROMSL PROLSL pedestals by 100mm increments

Code: EEXT100

Size: 100mm



L-Adapter

Suitable for side fixing aluminum or timber

Code: ELADAP



Stone Adapter

Suitable for structural tiles or pavers.

Code: ESTNADAP



Flex Stone Clip

Click into the EVO system for stone & tile

Code: EVOSTN



Stone Edge Clip

Prevent stone slabs from movement and retain perimeter tiles

Code: ESTNEDG



Click Adapter 60

Click EVO profile onto EPRO pedestals

Code: ECLPADP



Cork Deck Protection

Code: ECRK225

Size: 225mm x 225mm x 3mm. (10 pack)

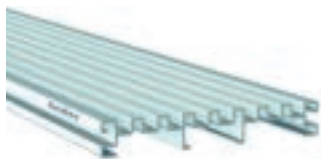

Drain-Tec Channel

Code: EDRAIN

Size: 21mm x 140mm x 4.0m



Fascia Board

Used with EPROM & EPROL. Support & Fix Fascia. (incl. bottom plate & side holder)

Code: EFASCIA



Flexible Ground Anchor

It allows a terrace to be extended even without a stable foundation

Code: EPROANCHOR

StormCell

High Load Bearing Support

The StormCell system offers flexible design whilst being light weight and high load bearing. The system has minimal componentry for rapid assembly on-site and offers a high void ratio enabling the best utilisation of space.

Vehicular options are available for creating traffic-able areas, and modules are stackable which ensures economical transportation and on-site storage.

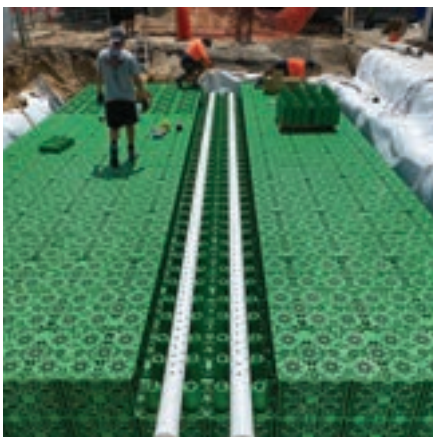

Benefits

» Speed of assembly

- » Easy placement of linear pipes with no drilling required
- » 50 ton per square metre safe working load
- » StormCells large voids ensure there are no barriers or trap points.
- » This allows for even easier distribution throughout the system- maximising the footprint for total soakage.
- » StormCell has been independently tested in New Zealand to guarantee vertical load and side integrity.
- » This testing is vital and ensures design engineers can have 100% faith in the product when faced with tight constraints on site.

Specifications

Crush load figures

Top: $\geq 505\text{kn} / \text{m}^2 @ 23^\circ\text{C}$

Side: $93\text{kn} / \text{m}^2 @ 23^\circ\text{C}$

Scope

Excavation depth of tank:

1m - 9m

Usable depth of tank: 0.6m - 9m

Backfill depth: 0.6m - 9m

Specifications

Length: 1000mm

Width: 500mm

Height: 400mm

Weight: 10kg

Void ratio: 95

Water storage: 195L

Calculation service and more data to be found on our website.

mwnz.com

Pro-Drain 8

Drainage Board

The protection board that creates a neutral pressure zone between the foundation wall and subsoil.



Benefits

- » Quick and easy to install
- » Provides continuous protection to the membrane
- » Follows contours of the substrate
- » Close dimple spacing provides high compressive strength - 250 kN/m² (25 t/m²) and stability
- » Provides drainage over the wall surface
- » Extremely durable
- » Resistant to a wide range of chemicals, impervious to root penetration, rot proof and unaffected by soil bacteria and fungi
- » Non-polluting for drinking water

Sheet sizes

- ✓ 2.1m x 1.2m

Installation

1. To hold sheets in place, apply Neutral Cure adhesive to raised dimples.
2. 100 Primer and Tak Spray can also be used. Check compatibility with substrate.
3. Place dimples against wall surface. Sheets can be laid horizontally or vertically.
4. A Chased Metal Flashing can be used to terminate the top of the ProWall and ProDrain 8.
5. 100 Primer and Protecto Tape.

Optional: Top edge can be sealed using 100 Primer and Protecto Tape to stop foreign material falling into cavity

Trade-Flash

The Flexible Back Flashing

Trade-Flash is an extrusion formed using two flat portions of hard uPVC that are joined together by a soft uPVC hinge. The middle section makes the Trade-Flash sufficiently flexible to be used as a flat, internal or external back flashing.

Trade-Flash is available 2.7m long and in two widths. One width of 200mm with the soft uPVC hinge 100mm in from each side and the other is 130mm wide with the soft uPVC hinge 65mm in from each side.

Trade Cavity Closer is 2.7m long x 75mm high x 20mm x 20mm punched extrusion. Used above windows and at the cladding base to provide drainage and ventilation of the cavity. The 75mm upstand is punched for easy fixing.



Internal Corners



External Corners

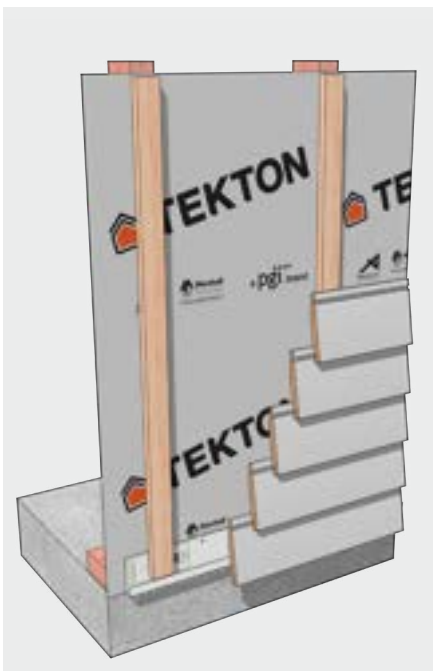

Wall

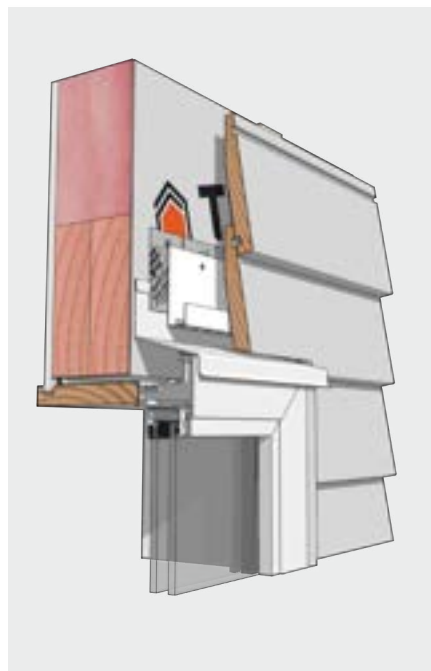

Windows

Benefits

- » Trade-Flash has a flexible centre hinge that allows the flashing to be used as a flat, internal, external or at any angle back flashing
- » Trade-Flash incorporates a hem on the outer edge of the flashing to contain any moisture
- » Trade-Flash is used behind exterior cladding junctions as a moisture barrier to ensure any water moisture that manages to get past the joint between the substrates is directed harmlessly to the outside of the dwelling
- » Trade-Flash is easy to cut and fit on site
- » Trade-Flash is manufactured from uPVC. This material has proven performance and shows compliance with NZBC Clause B2 Durability as detailed in B2/MM1

The Trade-Flash range offers a selection of premium concealed uPVC flashings. Designed with simplicity in mind to deliver solutions for a number of complex situations.

Pro-Kickout & Pro-Joist

Kick-Out Flashing & Sturdy Joist Support

Pro-Kickout

Kick-Out Flashing diverts water into the gutter at roof & wall junctions.

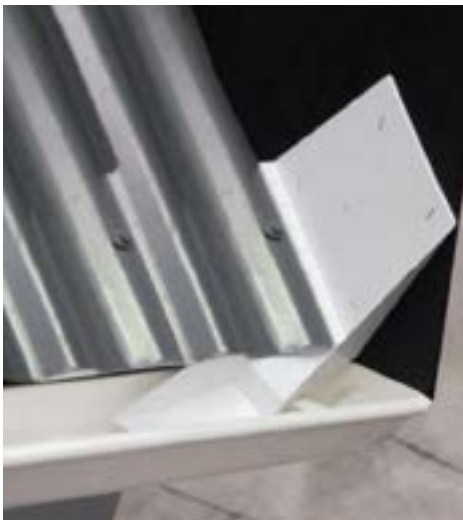

Pro-Joist

Reliable, durable cost effective saddle flashing.



For installation guides, please refer to our website mwz.com

Pro-Kickout Benefits

- » Pro-Kickout flashing is installed above the guttering and fixed under the apron flashing where the roof meets a vertical wall.
- » Pro-Kickout creates a downward and outward water flow off the roof and away from the wall, preventing water intrusion at roof to wall intersections.
- » Quality assured manufacturing
- » Formed as a single unit without any rivets or welds
- » Can be painted
- » UV Stabilised uPVC
- » NZ made

Left & right hand kick-out flashings are available.

Pro-Joist Benefits

- » Two widths to suit single (47mm) and double (94mm) timber joists
- » Suitable for joist depth up to 250mm
- » Saddle flashing you can cut to length on site
- » Reliable, durable cost effective saddle flashing
- » No laps, joins or rivet holes
- » Trouble free - will not crack or corrode
- » UV Stabilised Polypropylene
- » NZ made

Note: Must use Soudal BlackJack sealant between the Pro-Joist saddle Flashing and timber joist.



25

BUILDING ON
25 YEARS OF
INNOVATION
EST. NZ 1999

Get in touch

T. 0800 776 9727
admin@mwnz.com

Address

41 Hotuhotu Street,
The Lakes, Tauriko, Tauranga
PO Box 9411 , Greerton,
Tauranga, New Zealand

mwnz.com



Marshall
INNOVATIONS
CONSTRUCTION SOLUTIONS